

- * Cool it well and put it in the box when it is not in use.
- * Please use it indoors, and protect it against direct sun exposure or rain.
- * Please store it in a dry and ventilated place.

XIV. Suggestions

- * The warranty period of this product is one year. It is recommended to use original parts; otherwise, any failure thereof will not be covered by the warranty.



SUP ELECTRIC AIR PUMP

HT-737Plus Operation Instructions

Please fully charge the battery once at least per 6 months in order to be normal used of the product.

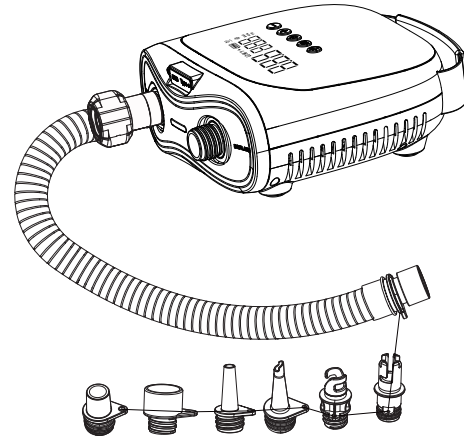

Please read the operation instructions carefully before using this product.
Please operate in the correct way based on complete understanding.

Catalogue

| | |
|---------------------------------------|-----|
| I. Warnings | 1 |
| II. Product Introduction | 1 |
| III. Product Parameters | 1 |
| IV. List of Accessories | 2 |
| V. Details of Accessories | 2-3 |
| VI. Inflation Operation | 3 |
| VII. Deflation operation | 3-4 |
| VIII. Precautions | 4 |
| IX. Charging | 4-5 |
| X.USB Charging Output Operation | 4 |
| XI. Outdoor lighting | 5 |
| XII. Fault Handling | 5 |
| XIII. Maintenance and Storage | 5-6 |
| XIV. Suggestions | 6 |

XI. Outdoor Lighting

- * In the standby status, it is turn on the light for the first time press LED lighting button, the LED light starts flashing for the second time press button, turn off the light for the third time press. The LED lighting can also be turned on or off during use.

XII. Fault Handling

| Malfunction | Cause | Solution |
|--|--|---|
| The air pump cannot be started normally. | 1.Check if the battery is fully charged. 2.Overheating or overload causes motor stop. | 1. Charge it in time 2. Cool the motor and restart it. 3. If the problem cannot be solved, please contact local agents or the similar authorized personnel. |
| Slow or abnormal inflation. | 1. Check whether the hose is blocked or cracked. 2. The joint between the hose and air pump or air bag is not installed properly. | 1. Change the hose or make it unblocked, and check whether the hose is cracked. 2. Reinstall the hose. 3. If the problem cannot be solved, please contact with the manufacturer or its service agent or the similar authorized personnel. |
| Hot | Temperature alarm | Heat dissipation is required. |
| E5 | Abnormal charging, the battery is overheated or too low. | 1. Heat dissipation is required. 2. Recharge for more than 30 minutes or longer to recover. 3. If the problem cannot be solved, please contact with the manufacturer or its service agent or the similar authorized personnel. |
| E3 | Shutdown protection without increasing air pressure | Check for air leaks. |
| U-L | Low power alarm of power supply (voltage lower than 10.5 V) | 1. Power supply voltage is low. 2. Power supply is insufficient. And line has limited current. 3. Power adapter overcurrent protection shall be used, requiring special adapter (120 W without current limit). |
| U-H | High input voltage alarm (over 17 V) | Standard power supply shall be selected. |
| LO/Hi E6 | Motor overcurrent protection | Check motor for foreign matter stuck or restart air pump. If the problem cannot be solved, please contact local agents or the similar authorized personnel. |
| Air pressure does not return to zero | Remove the connecting trachea. | Press and hold the pressure unit toggle button for more than 3 seconds to return to zero. |

XIII. Maintenance and Storage

- * Please remove the power plug from the electric outlet and turn off the power switch after use or before moving, servicing or adjusting the product.



III. List of Accessories

* Please make sure that the following accessories are in the box before using it, if any missing, please contact with the local agents or distributors.

| Air Pump | Hose | Air Nozzle |
|------------------|-------------------------|------------------|
| | | |
| Type-C USB Cable | Cigarette Lighter Cable | Instruction Book |
| | | |

IV. Details of Accessories

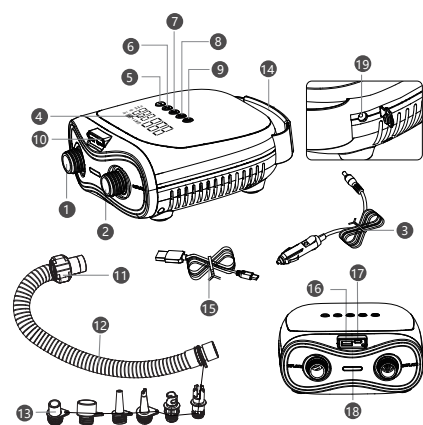

| | |
|---|------------------------------|
| ① | Inflation inlet |
| ② | Deflation outlet |
| ③ | Cigarette lighter cable |
| ④ | Highlight the LED display |
| ⑤ | Decompressing button |
| ⑥ | Pressurizing button |
| ⑦ | On/off button |
| ⑧ | Pressure unit toggle button |
| ⑨ | LED Button |
| ⑩ | Silicone Cover |
| ⑪ | Flexible conduit adaptor |
| ⑫ | Hose |
| ⑬ | Air nozzle |
| ⑭ | Handle |
| ⑮ | Type-C cable |
| ⑯ | USB charging output port |
| ⑰ | Type-C power input interface |
| ⑱ | LED Light |
| ⑲ | DC12V input port |



VI. Inflation Operation

- * Connect the end with flexible conduit adaptor of the hose with the air pump inflation inlet and twist clockwise to tighten it (Fig 1).
- * Install the other end of the hose into the supporting air tap of the air bag, and twist clockwise to tighten it, and then insert the inflation valve of the air bag and twist clockwise to fix it (Fig 2).
- * After finishing the above steps Press the On/Off button ☉ for 3 seconds to the display will light up short press the On/Off button ☉ open to start inflating or plug one end of the cigarette lighter cable into the product input interface (Fig 3) and insert the other end into the 12V DC socket (Fig 4), the display light up, short press the On/Off button ☉ to start inflating. Press the pressure unit toggle button ☉ to select the until you need.
- * Press the pressurizing button ☉ or decompressing button ☹ to set the pressure value you need, with the range of the pressure value from 0 to 20PSI, (1PSI=0.0689BAR=6.89KPA).
- * During the inflating process, you can press the pressurizing button ☉ or decompressing button ☹ to increase or reduce the pressure value, press the pressure unit toggle button ☉ to switch the unit and press the On/Off button ☉ to stop.
- * Press and hold the On/Off button for 3 seconds to directly start the high pressure pump. Notice: the completion of inflation, it will turn off automatically without other operations within 2 minutes. When the pressure reaches the set value, the air pump will stop working automatically.
- * After pulling out the cigarette lighter plug, please take down the hose from the air pump air bag and store it.
- * Notice: The factory set pressure value of the air pump is 20PSI (1PSI =0.0689BAR=6.89KPA), and at the time of the secondary use, the set pressure value for the last time use will be displayed by default.

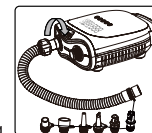

(Fig 1)

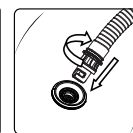

(Fig 2)

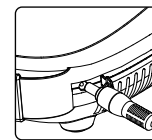

(Fig 3)

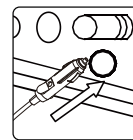

(Fig 4)

VII.Deflation Operation

- * Remove the hose from the inflation inlet, Connect the end with flexible conduit adaptor of the hose with the air pump deflation outlet and twist clockwise to tighten it (Fig 5) , and the other end shall still be to the air bag.
- In the standby status, Press the On/Off button ☉ open to start deflation, or plug one end of the cigarette lighter cable into the product input interface (Fig 3) and insert the other end into the 12V DC socket (Fig 4), the display light up, short press the On/Off button ☉ to start deflation, until all the gas is discharged and then press the On/Off button ☉ for 3 seconds to stop working.
- When not use, please take down the hose from the air pump air bag and store it.

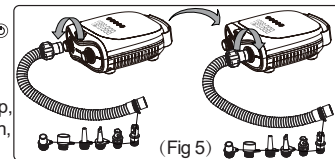



(Fig 5)

VIII. Precautions

- * The pump uses Type-C USB of 5V/2A or 9V/2A for charging, Product shall not be started during charging.
- * Do not block the inflation inlet and deflation outlet and ensure that the inflation inlet and deflation outlet shall remain smooth at all time.
- * Observe the local waste treatment provisions and it is not allowed to throw the air pump away randomly.
- * Don't use this product when the hose is damaged and please change the hose immediately.
- * Don't pull out the hose when inflating, because that the high pressure may hurt the physical body.
- * Don't make the air pump work for more than 20 minutes, because that motor overheating may cause internal damaged and the air pump shall be fully cooled for 30 minutes after continuously working up to 20 minutes.
- * Please don't use this air pump if any part is damaged, and please contact with the professional personnel to repair it.
- * In order to prevent risk, the inflation inlet shall not be forward to face or body.
- * Please don't leave while inflating.
- *  Disposal: Do not dispose of this product as unsorted municipal waste.
 - * The waste must be collected separately for special disposal.
- * The built-in batteries of this product must be removed from the equipment and disposed of properly before being scrapped.
- * Please fully charge the battery once at least per 6 months in order to be normal used of the product.
- * Please start the car when using the product in case of unnecessary damaged.
- * Do not charge and discharge when the product in the working state of charging and deflating.

IX. Charging

- * Please use type-C USB cable with this product for charging (When charge " " the indicators will flash during charging. In the fast charging mode, " " the red indicator remains on). Charging voltage is 5V/2A or 9V/2A. Charging voltage will automatically be identified (Fig 4).
- * Make sure the battery is fully discharged before the first charge. After the battery is discharged, the internal temperature is too high. It is recommended to cool it down before charging it. Do not let the electric air pump in a state of no electricity for a long time.

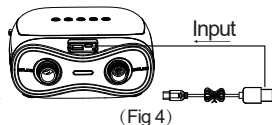

X. USB Port Output Operation

- * In standby or power-on state, Connect one end of the USB Cable to the USB/Charger Port on the pump and connect the other end to a USB port on your phone or other digital products. (as Fig 5)

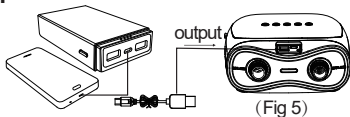

SUP ELECTRIC AIR PUMP

I. Warnings

- * **Warning:** Do not use the USB port to charge other products when the air pump is working. 
- * **Warning:** This appliance can be used by children aged from 8 years and above and persons with reduced physical, sensory or mental capabilities or lack of experience and knowledge if they have been given supervision or instruction concerning use of the appliance in a safe way and understand the hazards involved.
- * **Warning:** Children shall be kept far away from this product and wire.
- * **Warning:** This product shall not be exposed to the rain or immersed in water.
- * **Warning:** Before moving, maintaining, repairing or adjusting this product, please first pull out the cigarette lighter plug from the socket.
- * **Warning:** Please do not bury the wire in the soil, and it shall be place in the safe zone where it won't be damaged by mower or other equipment.
- * **Warning:** If the power wire is damaged, the power wire must be changed by the manufacturer or its service agent or the similar authorized personnel, in case of any risk.
- * **Warning:** If you are standing in a place with water or your hands are wet, please don't plug or pull the cigarette lighter plug.
- * **Warning:** Before inflating, please pay attention to check the maximum bearable pressure of the inflatable product, because the air bag may be damaged upon exceeding the maximum bearable pressure.
- * **Warning:** Before using, please check the cigarette lighter socket to make sure that there is no rust or residue inside. The cigarette lighter socket with poor electric conduction may cause overheating of the product or power source, which will damage the product.
- * **Warning:** The purpose of using this product is limited to the description in the instruction book.
- * **Warning:** The product cannot be used under flammable and explosive environment.
- * **Warning:** Please use this equipment at ambient temperature of no more than 40 degrees.
- * **Warning:** The pressure line of the product is only suitable for the original wave pipe.
- * **Warning:** Be sure to check if the wave pipe is broken, and make sure the switch, the cigarette lighter and the pressure screen really work prior to use.
- * **Warning:** Keep away from heat source, humidity, dust and direct sunlight.
- * **Warning:** Do not throw this product into fire for fear of explosion, battery leakage or other dangers.

II. Product Introduction

HT-737Plus is an intelligent power storage, air pump with Highlight the LED display with preset pressure value and it can inflate inflatable tents, inflatable beds, canoeing, etc. In addition, it has an intelligent pressure system. The air pump will automatically stop inflation when pressure reaches the preset pressure value.

This product also can deflate and when the inflatable product is not used, you can use the air pump to empty the air inside for folding and storage.

III. Product Parameters

| | | | |
|---------------|-------------------------|----------------|---------------------|
| Pressure | 0-20PSI | Charging input | USB 5V/2A or 9V/2A |
| Airflow | Low300L/min/High70L/min | USB output | 5V/2A |
| Battery | 4000mAh | Noise | ≤85dB |
| Power | 110W | Charging time | 5V/2A About 6 hours |
| Input voltage | DC12-17V | | 9V/2A About 4 hours |